

[W-11] 1/2" Reflective Green Glass Fixed Window 2' x 4' Aluminum Tubular Framing (White)

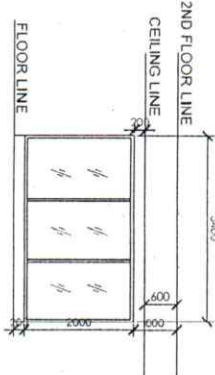

[W-12] 1/2" Reflective Green Glass Fixed Window 2' x 4' Aluminum Tubular Framing (White)

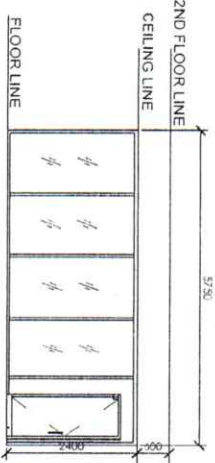

[W-13 @ Ground floor] 1/2" Reflective Green Glass Fixed Window 2' x 4' Aluminum Tubular Framing (White)

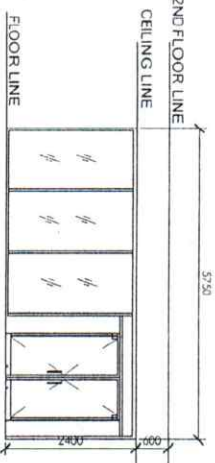

[W-13 @ second floor] 1/2" Reflective Green Glass Fixed Window 2' x 4' Aluminum Tubular Framing (White)

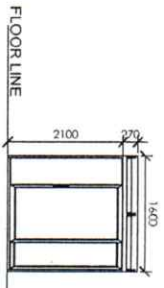

[D-1] AUTOMATIC SLIDING GLASS DOOR, MOTION DETECTOR ACTUATION, ELECTRO MECHANICAL HOLD-OPEN UNIT, FINISHED BI-PARTING OPENINGS



[D-2] 1/2" Heavy Duty Reflective Green Glass Door w/ 2' x 4" Aluminum Tubular Framing (White)

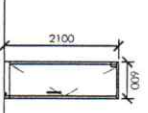

[D-3] Single Leaf Plastic Door

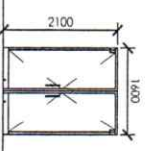

[D-4] 2 - Panel 1/2" Heavy Duty Reflective Green Glass Door w/ 2' x 4" White Aluminum Tubular Framing

PREPARED BY :

ROMBLON STATE UNIVERSITY

CIVIL ENGINEER

CHECKED BY :

JASON F. REYES

PROJECT TITLE :

REHABILITATION AND FURNISHING OF OLD/EXISTING UNIVERSITY LIBRARY

SHEET CONTENT :

AS SHOWN

PREPARED BY :

CAD OPERATOR

BSCC / SIM

JOB NO. :

DATE :

PRC REG. No. 42850 Validity 09/21/2023
 PTR No. 8124941 Date: 1/21/2020
 Place: CDOCKAHN TN: 915-048-948

APPROVED BY :
 SHIRVAN ATAYANUSIE D. CRIS
 ASST. President

LOCATION : ROMBLON STATE UNIVERSITY - Main Campus, Linares, Odiongan, Romblon