

SHEET F	SHEET CONTENT GROUND FLOOR PLUMBING LAYOUT	DRAWN BY 	APPROVED BY  ARNULFO DE LUNA, Ph.D SUB. PRESIDENT II	RECOMMENDING APPROVAL  EMELIA B. RAMOS, Ph.D CAMPUS DIRECTOR	OWNER 	PROJECT TITLE REHABILITATION OF MULTI-PURPOSE BUILDING I IN SAN FERNANDO CAMPUS	LOCATION: BSI SAN FERNANDO, CAMPUS POBLACION, SAN FERNANDO, ROMBLON
-------------------	---	------------------	---	---	---------------	---	---

SANITARY ENGINEER:

PROAR NOLASCO
 STRUCTURAL ENGINEER
 PRC REG. NO. 10455
 PRC REG. DATE: 12-11-21
 DATE ISSUED: 1-18-23
 FID - ROMBLON

P-1

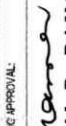
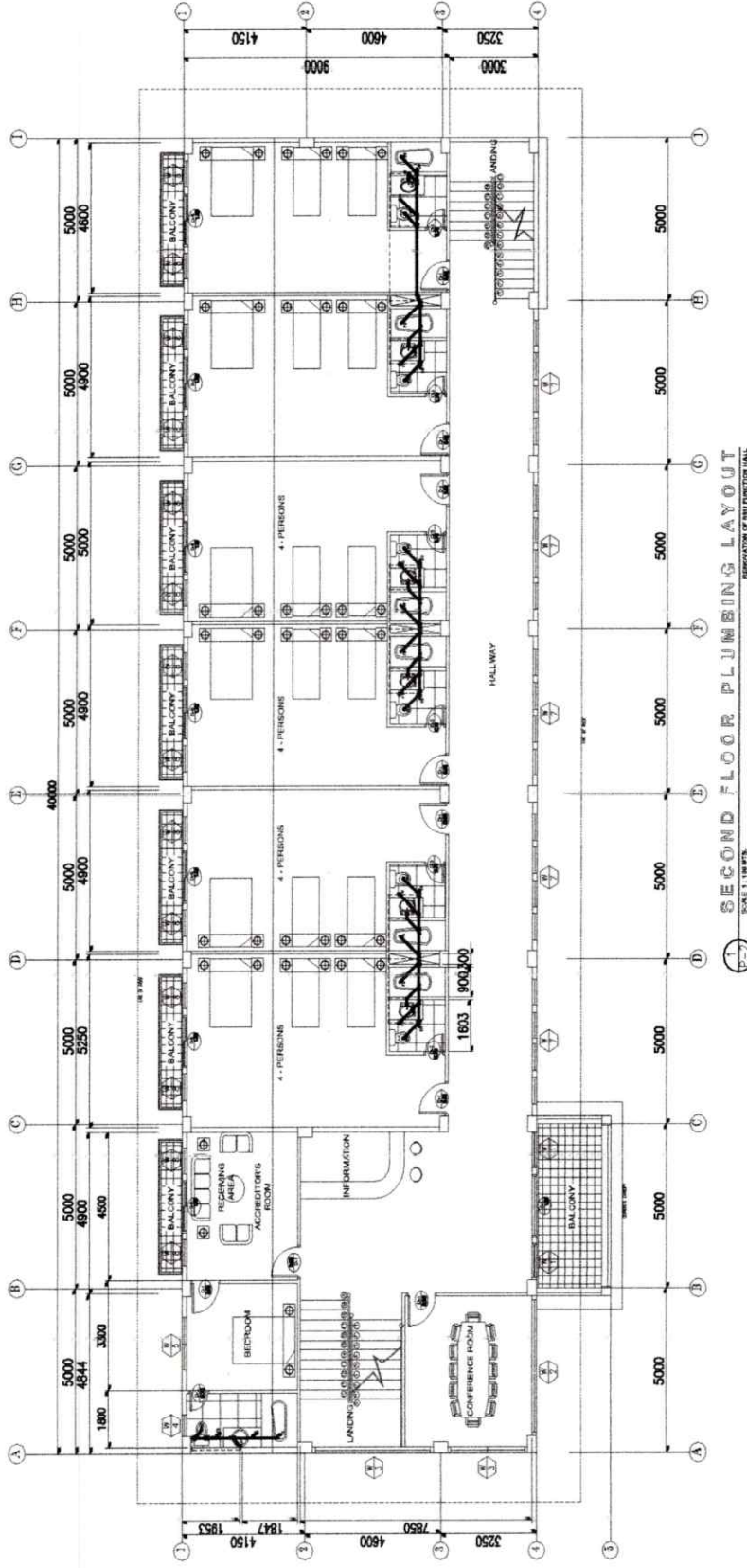

SECOND FLOOR PLUMBING LAYOUT
REHABILITATION OF MULTI-PURPOSE BUILDING
SCALE: 1/8" = 1'-0"

SHEET CONTENT SECOND FLOOR PLUMBING LAYOUT	DRAWN BY:	APPROVED BY: <i>[Signature]</i> ARNULFO DE LUNA, Ph.D. SUD. PRESIDENT III	RECOMMENDING APPROVAL: <i>[Signature]</i> EMELIA B. RAMOS, Ph.D. CAMPUS DIRECTOR	OWNER	PROJECT TITLE:	SHEET
					REHABILITATION OF MULTI-PURPOSE BUILDING IN SAN FERNANDO CAMPUS	27
PRC NO:	VALID UNTIL:				LOCATION: PUSAN FERNANDO, CAMPUS POBLACION, SAN FERNANDO, ROMBLON	
PTR NO:	PLACE:					
DATE ISSUED:						

P-2

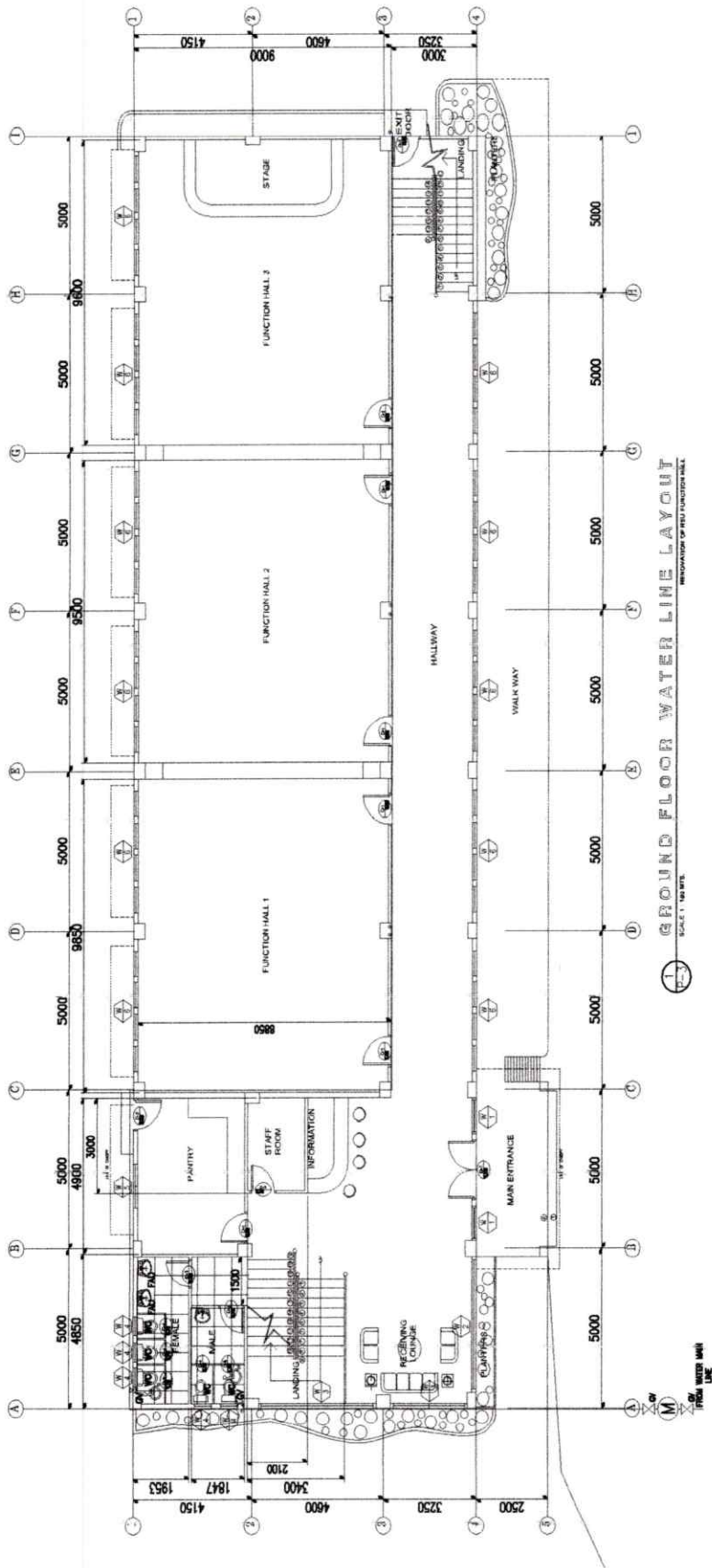

GROUND FLOOR WATER LINE LAYOUT
SCALE: 1:100 NTS.
RESPONSIBILITY OF THE ARCHITECT

SANTARY ENGINEER:	PROJECT TITLE:	OWNER:	RECOMMENDING APPROVAL:	APPROVED BY:	DRAWN BY:	SHEET CONTENT:	SHEET:
PRC NO: PTR NO: DATE ISSUED:	VALID UNTIL: PLACE: DATE ISSUED:						

P-3