

1 GROUND FLOOR PLUMBING LAYOUT PLAN
 1:200 SCALE

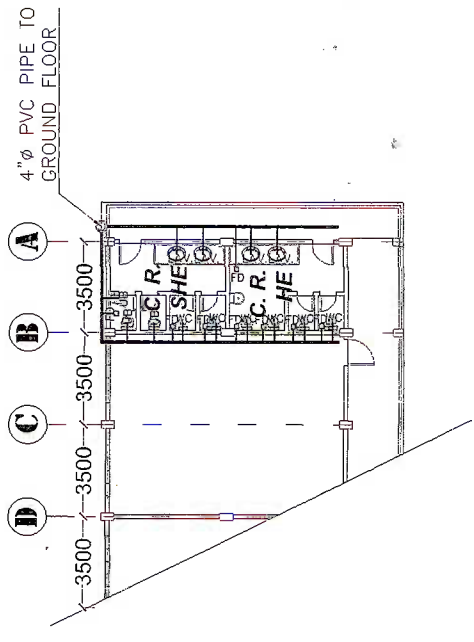

2 SECOND FLOOR PLUMBING LAYOUT PLAN
 1:200 SCALE

PREPARED BY: CAD OPERATOR Newel M. Botoni JOB NO. : DATE : JUNE 2017	SHEET CONTENT: AS SHOWN	PROJECT TITLE: CONSTRUCTION OF 2 - STOREY ACADEMIC BUILDING FOR THE COLLEGE OF ENGINEERING AND TECHNOLOGY (CET)	LOCATION: ROMBLON STATE UNIVERSITY - Main Campus, Libranang, Odiongan, Romblon
<div style="text-align: center; border: 1px solid black; border-radius: 50%; width: 40px; margin: 0 auto; padding: 5px;">P-1</div>			
MASTER NUMBER: ARCH. NO. 17-03-001 PRC NO. 2017-001 PRC REG. NO. 17-03-001 PRC REG. NO. 17-03-001 PRC REG. NO. 17-03-001	CHECKED BY: JEROME ADORNO F. FAJARITO REGISTERED PLUMBER REGISTERED PLUMBER REGISTERED PLUMBER REGISTERED PLUMBER	DATE: JUN 2017	OFFICE OF AUXILIARY, MAINT SERVICES AND POLLUTION CONTROL UNIT

PLUMBING NOTES :

1. ALL SANITARY WORKS INCLUDED HEREIN SHALL BE EXECUTED ACCORDING TO THE PROVISIONS OF THE NATIONAL PLUMBING CODE OF THE PHILIPPINES, NATIONAL BUILDING CODE OF THE PHILIPPINES AND ITS IMPLEMENTING AND REGULATIONS.
2. COORDINATE THE DRAWING WITH THE OTHER RELATED DRAWINGS AND SPECIFICATIONS. THE ARCHITECT AND/OR THE ENGINEER SHALL BE NOTIFIED IMMEDIATELY OF ANY DISCREPANCY FOUND THEREIN HIS/HER DECISION SHALL BE FINAL.
3. ALL PIPES SHALL BE INSTALLED AS INDICATED ANY RELOCATION REQUIRED FOR PROPER EXECUTION OF OTHER TRADES SHALL BE WITH PRIOR APPROVAL OF THE ARCHITECT/ENGINEER.
4. PROPOSED SANITARY UTILITIES SHALL CONFORM TO THE ACTUAL LOCATION, DEPTH AND INVERTED ELEVATION OF EXISTING PIPES AND STRUCTURES AS VERIFIED BY THE CONTRACTORS.
5. THE CONTRACTORS SHALL BE RESPONSIBLE FOR ALL REQUIRED FLOOR AND WALL OPENINGS.
6. ALL SLOPE FOR HORIZONTAL DRAINAGE SHALL MAINTAIN 1% MINIMUM UNLESS OTHERWISE NOTED.
7. SIZE OF WATER SUPPLY PIPES TO FIXTURES SHALL BE IN ACCORDANCE WITH THE MANUFACTURER'S INSTRUCTIONS.

SPECIFICATIONS :

1. ALL HORIZONTAL PIPINGS SHALL BE RUN IN PRACTICAL ALIGNMENT AND AT UNIFORM UNIFORM GRADE NOT LESS THAN 2% AND SHALL BE SUPPORTED OR ANCHORED AT INTERVAL NOT TO EXCEED 10 FT.
2. ALL PIPES PASSING THRU OR UNDER WALLS AND DRIVEWAYS SHALL BE PROPERLY PROTECTED AGAINST BREAKAGE.
3. WORKMANSHIP SHALL BE OF SUCH CHARACTER AS TO FULLY SECURE THE RESULTS SOUGHT IN ALL PROVISION OF THE NATIONAL PLUMBING CODE INCLUDING THE FURNISHING 5 OF ALL FITTINGS, TRAPS, VALVES AND ACCESSORIES REQUIRED FOR PROPER PLUMBING SYSTEM.

LEGEND :

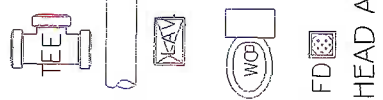

PLAN VIEW

4" PVC TEE CONNECTION

4" PVC PIPE

LAVATORY

WATER CLOSET

FLOOR DRAIN

SH SHOWER HEAD AND WATER FAUCET
WF WYE CONNECTION

WATER LINE

SEPTIC LINE

4" PVC WYE CONNECTION



SEPTIC VAULT

4" 60° PVC CONNECTION



C.O.

SEPTIC LINE

4" PVC WYE CONNECTION

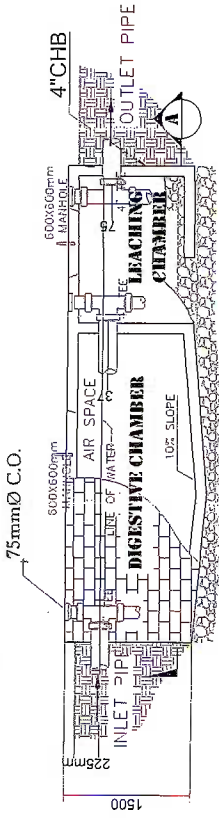

I PLAN OF SEPTIC VAULT

1:50

SCALE

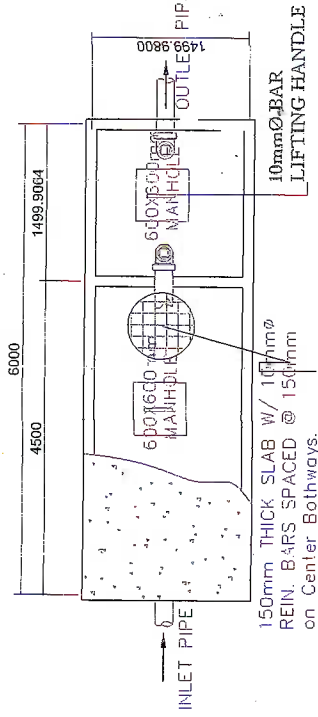

PLAN VIEW



SEPTIC VAULT

4" 60° PVC CONNECTION



C.O.

SEPTIC LINE

4" PVC WYE CONNECTION

PREPARED BY : ROMBLON STATE UNIVERSITY OFFICE OF AUXILIARY, PLANT SERVICES AND POLLUTION CONTROL UNIT	MASTER PLUMBER: ARON J. GONZALES REGISTERED PLUMBER REG. NO. 923-693-905 REGISTERED PLACE ISSUED:	CHECKED BY: <i>[Signature]</i> BERNARDO A. SOLER, JR., ENGINEER REGISTERED PROFESSIONAL ENGINEER REG. NO. 923-693-905 REGISTERED	PROJECT TITLE: CONSTRUCTION OF 2 - STOREY ACADEMIC BUILDING FOR THE COLLEGE OF ENGINEERING AND TECHNOLOGY (CET)	SHEET CONTENT: AS SHOWN	PREPARED BY: CAD OPERATOR: NEWELL M. BOLONI JOB NO.: DATE: JUNE 2017
	PTR No.: Date: Place:	LOCATION: ROMBLON STATE UNIVERSITY - Main Campus, Bantog, Romblon, Bataan	LOCATION: ROMBLON STATE UNIVERSITY - Main Campus, Bantog, Romblon, Bataan	LOCATION: ROMBLON STATE UNIVERSITY - Main Campus, Bantog, Romblon, Bataan	LOCATION: ROMBLON STATE UNIVERSITY - Main Campus, Bantog, Romblon, Bataan

P-2