

1 GROUND FLOOR C. 0. LAYOUT PLAN
 E-3-E-3 SCALE
 1:200

PREPARED BY : ROHMAN STATE UNIVERSITY OFFICE OF AUXILIARY PLANT SERVICES AND POLLUTION CONTROL UNIT	ELECTRICAL ENGR. AND ARCHITECT PROF. DR. H. ANTONI ADDRESS : Jember, Indonesia TEL : 0331-831111 Date : 15-09-2016 Place : Jember	CHECKED BY : PROF. DR. H. ANTONI ADDRESS : Jember, Indonesia TEL : 0331-831111 Date : 15-09-2016 Place : Jember	PROJECT TITLE : CONSTRUCTION OF 2- STORRY ACADEMIC BUILDING FOR THE COLLEGE OF ENGINEERING AND TECHNOLOGY (CET) PHASE I LOCATION : ROHMAN STATE UNIVERSITY - Jalan Cendekia Kecamatan Otono, Kabupaten Jember	SHEET CONTENT : GROUND FLOOR C. 0. LAYOUT PLAN	CAD OPERATOR : Heru Pratomo JOB NO. : DATE : JULY 2016
--	--	--	--	--	---

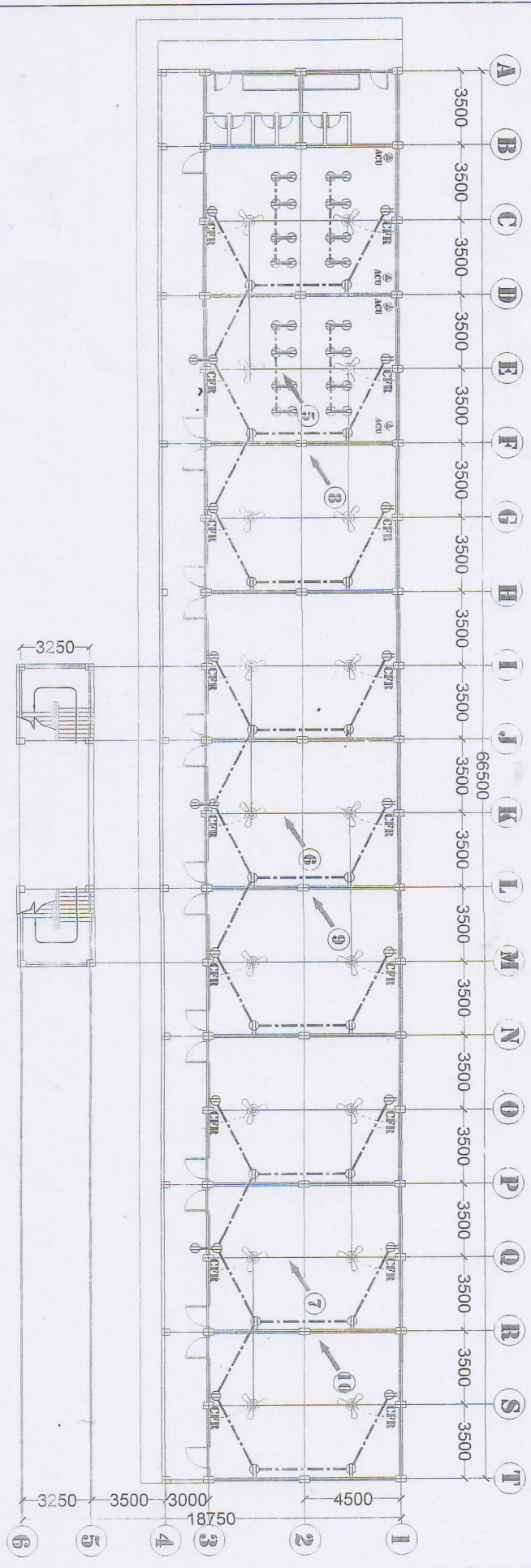

1 SECOND FLOOR C. O. LAYOUT PLAN
 E4/E4 SCALE
 1:200

PREPARED BY: ROMBION STATE UNIVERSITY OFFICE OF AUXILIARY PLANNING SERVICES AND POLAIPUPON CONTROL UNIT		ELECTRICAL ENG. NO. [Signature] PROJECT NO. 1000 E PRC REG. NO. 177 Nalady PTR NO. [Signature] Date: 1-5-2017 Place: [Signature]		CHECKED BY: [Signature] APPROVED BY: [Signature] M.L.A. ANSELMO ADELUNA 1st Professor		PROJECT TITLE: PROPOSED 2 - STD-BY ENGINEERING ACADEMIC BUILDING LOCATION: ROMBION STATE UNIVERSITY - Area C - [Signature] [Signature], [Signature], [Signature]		SHEET CONTENT: SECOND FLOOR C. O. LAYOUT PLAN		CAD OPERATOR: [Signature] JOB NO.: [Signature] DATE: JULY 2016		E-4	
---	--	---	--	--	--	---	--	---	--	---	--	------------	--